

ECOPHON HYGIENE ADVANCE™ WALL C3



Ecophon Hygiene Advance Wall C3 is a sound-absorbing wall panel system intended for use in environment where there is a high level of contamination, and where frequent cleaning is required. It is intended for use on walls above the occupied area or where there is no risk for mechanical impact. Examples of applications: healthcare premises and in areas with high levels of airborne grease, areas exposed to splatter from meat juices, fruit juices or other liquids.

The system consists of Ecophon Hygiene Advance Wall panel, which has a core of high density glass wool encapsulated in a smooth high-performance film that is impervious to particles and water. The film is also dirt-repellent and resistant to most chemicals. The fixing details Connect Wall fixing C3 are made of stainless steel wire. The panel is positioned with an airgap of 40 mm to the surface behind allowing for air to circulate and for cleaning. The weight of the system is approximately 3 kg/pcs.



Hygiene Advance Wall



Hygiene Advance Wall C3 system



Connect Wall fixing C3



SYSTEM RANGE

Size, mm	1200 x 600
Special Fixing	•
Thickness	40
Inst. Diagr.	M258

TECHNICAL PROPERTIES

ACOUSTIC Sound Absorption Test results according to EN ISO 354. Classification according to EN ISO 11654.

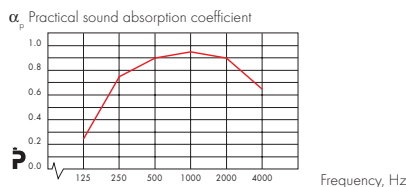

– Ecophon Hygiene Advance Wall C3, 80 mm o.d.s.
(refers to the surface of the panel)
o.d.s= overall depth of system

Product	Hygiene Ad- vance Wall C3
o.d.s mm	80 (refers to the surface of the panel)
absorption class	B
α_w	

Sound Insulation Not applicable.

Sound Privacy Not applicable

ACCESSIBILITY The tiles are demountable.

CLEANABILITY Daily dusting, vacuum cleaning, manual wet cleaning, high-pressure washing and steam cleaning. Water temperature max. 70°C. Can withstand the use of common disinfecting chemicals.

VISUAL APPEARANCE White 141, nearest NCS colour sample S 1000-N, 73% light reflectance.

INFLUENCE OF CLIMATE The tiles withstand a permanent ambient RH up to 95% at 30°C without sagging, warping or delaminating (ISO 4611). A higher temperature/moisture is permissible during washing as stated above. The grid and accessories meet the demands of corrosion class C3 according to EN ISO 12944-2. For the microbiological resistance see Functional demands, Influence of climate.

INDOOR CLIMATE Can be used in rooms classified as ISO class 4 according to ISO 14644-1.

ENVIRONMENTAL INFLUENCE Fully recyclable

FIRE SAFETY The glass wool core of the tiles is tested and classified as non-combustible according to EN ISO 1182. See Functional demands, Fire safety.

Reaction-to-fire classification		
Country	Standard	Class
Europe	EN 13501-1	A2-s1,d0

MECHANICAL PROPERTIES For information regarding live load and requirements for load bearing capacity, see installation diagrams. Conditions: See Functional demands, Mechanical properties.

INSTALLATION Installed according to system range which includes information regarding minimum overall depth of system.

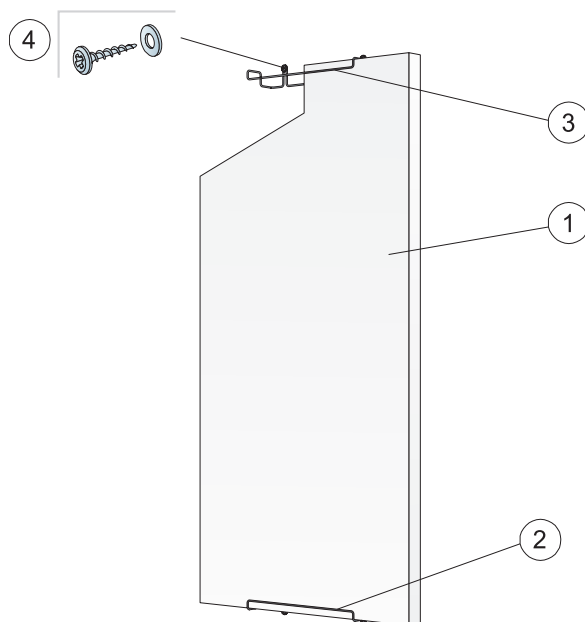

© Ecophon Group

QUANTITY SPECIFICATION (EXCL. WASTAGE)

		Size, mm
		1200x600
1	Ecophon Hygiene Advance Wall	1,4/m ²
2	Connect Wall fixing C3, vertical installation	2/panel
3	Connect Wall fixing C3, horizontal installation	4/panel
4	Wall screw, A2 material (not supplied by Ecophon)	2/wall fixing

Δ Min. overall depth of system: 90 mm

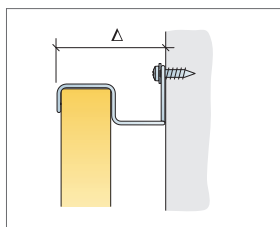

See Quantity specification

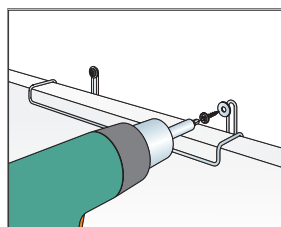

Installation with wall screw in stainless steel (A2) material

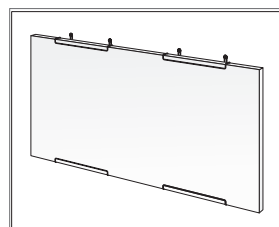

Horizontal installation of Advance Wall C3

Size, mm	Max live load [N]	Min load bearing capacity [N]
1200x600	0	-

Live load/load bearing capacity